

**ASCENSORE DA CANTIERE
CONSTRUCTION HOIST**

EHP 800

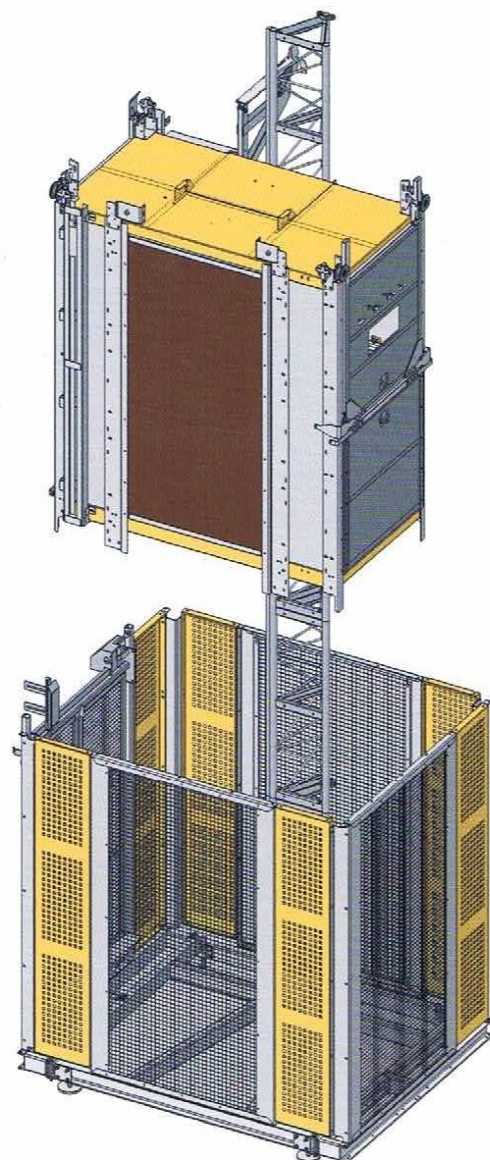
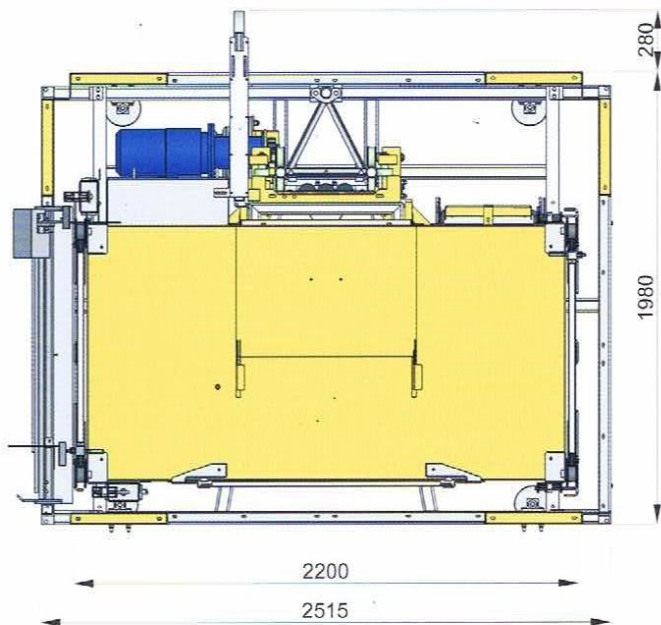

CAPACITÀ DI CARICO PAYLOAD

↑↑↑↑↑↑↑↑ o/or 800kg

Dati tecnici	Technical Data	Données Techniques	Datos Tecnicos	EHP800
Capacità di carico	Capacity	Charge Nominale	Capacidad de carga	↑x10 o/or 800 kg
Capacità di carico durante il montaggio	Erection load	Charge nominale pendant le montage	Capacidad de carga durante el montaje	800 kg
Velocità di sollevamento	Lifting speed	Vitesse de lévage	Velocidad de elevación	25/30 m/min
Massima altezza ancorata	Max anchored height	Hauter max avec ancrages	Altura max con anclajes	120 m
Dimensioni interne della cabina	Internal cage dimensions	Dimensions internes de la cabine	Dimensiones interno cabina	1120 x 2095 mm
Apertura porte	Doors opening	Ouverture des portes	apertura puertas	0,98 x 2 m
Potenza 15% servizio intermittenza	Rated power 15% intermittence duty	Puissance 15% service intermittence	Potencia 15% servicio intermitenciaù	2 x 6 kW
Tensione alimentazione	Input power range	Tension d'alimentation	Tensión de red	380/400V 50/60Hz 3Ph
Interruttore protezione linea	Protection switch	Interrupteur de protection	Interruptor de protección	32 A
Potenza servizio continuo	Power of the motors	Puissance des moteurs	Potencia de motorreductores	2 x 4 kW
Corrente di spunto	Starting current	Ampérage au démarrage	Intensidad de arranque	130 A
Minima potenza di linea consigliata	Minimum line power suggested	Min. puissance de ligne conseillée	Min. potencia de linea	12 kW

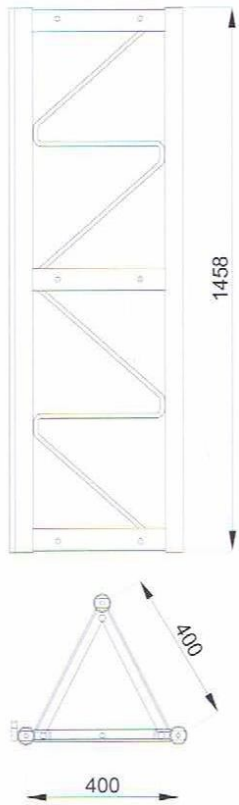

Compatibile con:
Interchangeability:

- EHM 400mini
- EHM 1000mini
- EHM 500
- EHM 700
- EHM 900
- EHM 1200
- EHM 2500/15
- EHM 2500/25
- EPHM 400mini
- EPHM 1000mini
- EPHM 500
- EPHM 700
- EPHM 900
- EPHM 1200
- EPHM 2500/15
- EPHM 2500/25
- EHP 400
- EHP 800

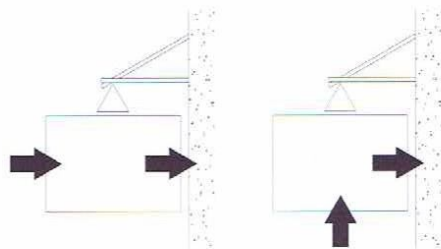

Configurazioni d'accesso possibili
Possible access configurations

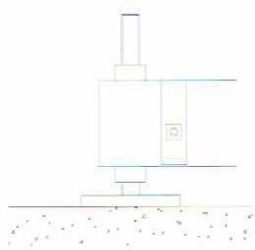

Quattro viti di livellamento
Four levelling screw-jacks

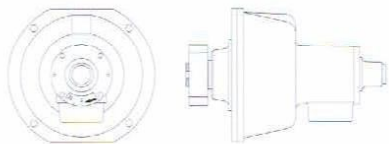

Freno d'emergenza
ad arresto progressivo
*Overspeed safety device
with progressive stop*

EHP 800

